

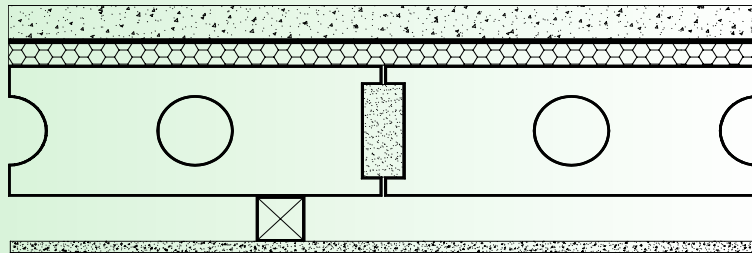

## SEPARATING FLOOR



40mm Gyvlon levelling screed laid over  
5mm Ethafoam on 25mm polystyrene

150mm Tarmac Widespan precast concrete floor slab  
(300kg/m<sup>2</sup>)

12.5mm plasterboard on 50mm x 50mm timber battens

**SITE**  
**TEST ORGANISATION**  
**REPORT / TEST No. / TEST DATE**  
**TEST METHOD**  
**RESULTS**

Paper Mill Lane, Alton, Hampshire  
Philip E Jones  
031101 / 03/11/01 and 01i / 18th November 2003  
BS EN ISO 140-4 and 7: 1998  
DnT,w (C ; Ctr) - 55 (-3 ; -7) Db  
DnT,w + Ctr - 48 dB  
L'nT,w (CI) - 60 (-3) dB

### FLOOR CONSTRUCTION

- 150mm Tarmac Widespan precast concrete floor slab (300kg/m<sup>2</sup>) built into walls on all sides.
- Joints between blocks and beams sealed with sand cement grout mix.
- 5mm Ethafoam over 25mm polystyrene
- 40mm Gyvlon levelling screed applied over a polyethylene slip-sheet with a perimeter strip of 8mm polyethylene foam.
- A ceiling comprising 12.5mm plasterboard fixed to 50mm x 50mm timber battens

The results show that this floor system, as tested in conjunction with the associated constructions detailed above, is able to achieve the sound insulation performance required in the Building Regulations 2000, Approved Document E, 2003 Edition.

If this floor system were to be used on site with an equivalent construction and same build quality, similar results would be expected.

### BUILDING CONSTRUCTION DETAILS

#### General

Newly built block of flats comprising cavity brick/ block external walls, cavity block separating walls and precast concrete separating floors

#### External walls

100mm brickwork / 85mm cavity (35mm Kingspan Kooltherm K8 batts plus 50mm clear) / 100mm dense concrete blocks (7N/mm<sup>2</sup>) inner leaf. Blockwork lined internally with 12.5mm plasterboard dab fixed.

#### Separating walls

215mm cavity wall comprising 100mm dense concrete blocks (7N/mm<sup>2</sup>) laid flat.  
Both sides lined with 12.5mm plasterboard dab fixed.

LAFARGE GYVLON FLOWING SCREED  
ACOUSTIC TEST DATA SHEET - 19

Lafarge Gyvlon Ltd

Europa Boulevard, Westbrook Warrington WA5 7TN

Phone: 01925 428780 Fax: 01925 428788

Email: sales@gyvlon.co.uk

