

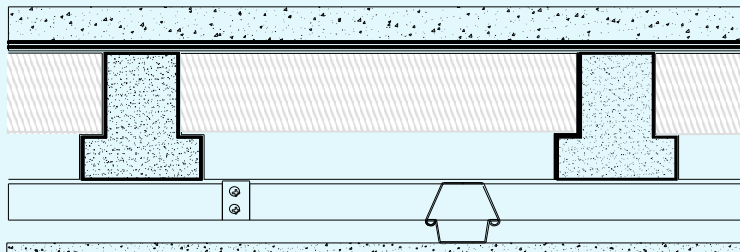

Acoustic Test Data Sheet 26

SEPARATING FLOOR



40mm Gyvlon levelling screed
Two layers of 5mm Ethafoam

150mm concrete beam and block
floor (300kg/m²)

One layer of 12.5mm Lafarge dBcheck
wallboard on MF system with 75mm cavity

SITE
TEST ORGANISATION
REPORT / TEST No. / TEST DATE
TEST METHOD
RESULTS

Laboratory
Sound Research Laboratories Ltd
C/03/5L/0837/1 / Tests A7 and I7 / 9th & 10th December 2003
BS EN ISO 140-4 and 7: 1998
DnT,w (C ; Ctr) - 52 (-2 ; -5) Db
DnT,w + Ctr - 47 dB
L'nT,w (CI) - 57 (0) dB

FLOOR CONSTRUCTION

- 150mm concrete beam and block floor (300kg/m²) built into cavity block walls on four sides.
- Where beams were running parallel to walls, tray blocks with insitu concrete were installed.
- Joints between blocks and beams sealed with sand cement grout mix.
- Two layers of 5mm Ethafoam butt jointed and taped.
- 40mm Gyvlon levelling screed applied over a polyethylene slip-sheet with a perimeter strip of 8mm polyethylene foam.
- A ceiling comprising one layer of 12.5mm Lafarge dBcheck wallboard fixed to the MF ceiling system with a clear cavity of 75mm.

The results show that this floor system, as tested in conjunction with the associated constructions detailed above, is able to achieve the sound insulation performance required in the Building Regulations 2000, Approved Document E, 2003 Edition.

If this floor system were to be used on site with an equivalent construction and same build quality, similar results would be expected.

BUILDING CONSTRUCTION DETAILS

Sound Research Laboratories Ltd., flanking transmission test laboratory at Holbrook House, Little Waldingfield, Sudbury, Suffolk. A two-storey purpose built test unit comprising cavity dense concrete block walls, a concrete beam and block first floor and a flat timber joist roof. Single rooms at ground and first floor level each approximately 25m³ with a separating floor area of 10m².

Two leaves of 100mm dense concrete blocks with a 50mm cavity with wall ties at 600mm centres horizontally and 450mm vertically. 50mm Rockwool cavity closer (45kg/m³) running horizontally at the separating floor junction. Internal faces of block work finished with 12.5mm standard grade (Type 1) plasterboard fixed on plaster dabs.

The information above must NOT be reproduced without the prior written consent of Lafarge Gyvlon Ltd Issue 2—Revision 0—01-12-10

Lafarge Gyvlon Limited

Unit 221 Europa Boulevard,
Westbrook, Warrington WA5 7TN

sales@gyvlon.co.uk
01925 428780



www.gyvlon.co.uk



Calcium Sulfate binder
EN 13454-CAB-30



greenspec®